

# Anchor Bath Chair & Accessories

USER MANUAL

## Item #s

Anchor Bath Chair

AN1400

AN1600

## Accessories

Rolling Shower Base

AN2100

Lateral Support

AN2110

Positioning Belts, XL

AN2111



Obelis S.A.  
Bd. Général Wahis 53  
B-1030 Brussels, Belgium  
Max User Mass 70.25 kg/155 lbs



[www.circlespecialty.com](http://www.circlespecialty.com)

# INTRODUCTION

## **Thank you for purchasing the Anchor Bath Chair!**

To safely operate and maintain your bath chair, please read this User Manual carefully before using and save it for future reference. Taking proper care of your bath chair will ensure longevity and that you fully benefit from its features.

# SAFETY

## **Incorrect use of the bath chair can cause serious injury.**

- Never leave child unattended in this product. When in use, the child must be strapped in. Before use, ensure that the cover, headrest, and all positioning straps are securely fastened.
- Check water temperature before the child is placed in the bath.
- Do not adjust height while child is seated in the bath chair.
- Back recline adjustment can be made during use. Lift child slightly forward away from the back support when doing this adjustment.

# GENERAL USE

Unpack the bath chair and prepare for use.

Your Anchor Bath chair arrives folded in one box and it includes a headrest, 2 positioning belts and leg straps.

Remove headrest strap from bottom side of frame and mount on front side. Wrap edges of headrest strap under frame and attach to hook and loop fastener.

# ADJUSTMENTS

⚠ Secure bath chair when any adjustment has been made.

⚠ Never place your finger underneath the black flaps on the frame to avoid pinching your finger and causing injury.

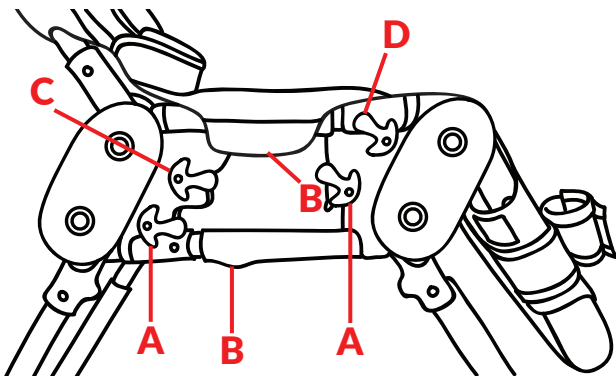
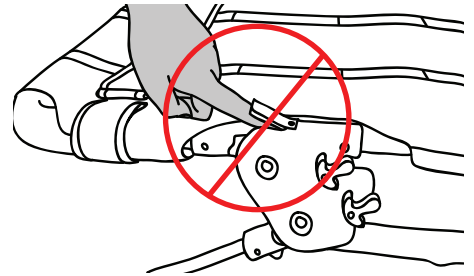

**Seat Height** - Raise or lower the legs by turning either of the four lower red levers **(A)**.

**Seat Depth** - Unfasten the fabric beneath the calf support from the hook and loop strip. Loosen but do not remove the four screws **(B)** on the telescoping tube and adjust to desired position by pulling the frame outward or inward. Replace the fabric beneath the calf support.

**Back Angle** - Turn either of the two top rear red levers **(C)** and angle the back to desired position. The back can

be positioned to four positions.

**Calf Support Angle** - Turn either of the two top front red levers **(D)** and angle the calf support to desired position. It can be adjusted to four positions.

**Seat Angle** - Position front legs higher than rear leg position achieve seat angle.

**Head Support** - Unfasten the strap in the back of the chair and place at the desired position. Wrap edges of headrest strap under frame and attach to hook and loop fastener. Adjust head wedges in width by sliding along the width of the strap.

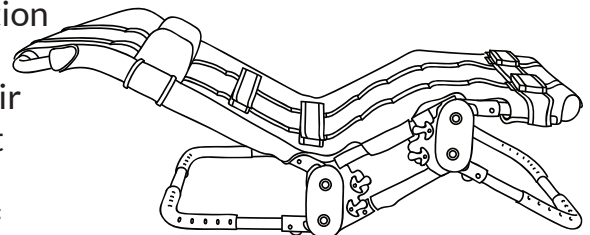

NOTE: The Head Support can be used as a lateral support. The Lateral Support can be ordered as an accessory.

**Positioning Belts** - Insert the positioning belt into the appropriate loop on the two black vertical positioning strips along the bath chair. Wrap around child and secure with hook and loop.

NOTE: Longer XL Positioning Belts can be ordered as an accessory.

**Leg Support Belt** - Insert the leg support belt into the appropriate loop on the two black vertical positioning strips along the bath chair and secure around the frame. Place ankle positioners at desired position on the leg support belt.

# CARE AND MAINTENANCE

- Wash the Anchor bath chair on a frequent basis.
- The cover and the support belts are easily removed and can be machine washed in warm water with mild detergent.
- Engage all hook and loops before washing.
- Use mild soap and water to wash the frame and dry with a cloth. If used with chlorinated water, wash after each use.
- After cleaning, make sure the bath chair is dry before next use.

## **Inspect the Anchor Bath Chair before use.**

- Adjustment levers must be secure and in place.
- Check hook and loop strips for signs of wear.
- Screws (B) underneath the bath chair should be checked periodically to assure stability.

# LIMITED 2-YEAR WARRANTY

This warranty is solely for the benefit of the original consumer purchaser and is in effect from date of purchase.

Circle Specialty Inc. warrants that the Anchor bath chair will be free from defect for a period of three (2) years.

The warranty does not extend to non-durable components which are subject to normal wear and tear and need periodic replacement.

This warranty does not cover device failure due to owner misuse or negligence. It only applies when product is used according to the specified conditions and for the intended purposes.

If within the warranty period any such product shall be proved defective, such product will be repaired or replaced at Circle Specialty's option.

If you have a question about your Circle Specialty bath chair or this warranty, please contact an authorized dealer.

## **NOTE:**

**We regretfully cannot accept returns for bathing and toileting products due to public hygiene concerns.**



Circle Specialty, Inc.  
Brooklyn, NY 11232, USA  
718.943.6452  
info@circlespecialty.com

2020/Rev 3-20